

Marking Liquid Petroleum Pipeline Facilities

API RECOMMENDED PRACTICE 1109
FOURTH EDITION, OCTOBER 2010

ERRATA, NOVEMBER 2010



AMERICAN PETROLEUM INSTITUTE

Marking Liquid Petroleum Pipeline Facilities

Pipeline Segment

API RECOMMENDED PRACTICE 1109
FOURTH EDITION, OCTOBER 2010

ERRATA, NOVEMBER 2010



AMERICAN PETROLEUM INSTITUTE

Special Notes

API publications necessarily address problems of a general nature. With respect to particular circumstances, local, state, and federal laws and regulations should be reviewed.

Neither API nor any of API's employees, subcontractors, consultants, committees, or other assignees make any warranty or representation, either express or implied, with respect to the accuracy, completeness, or usefulness of the information contained herein, or assume any liability or responsibility for any use, or the results of such use, of any information or process disclosed in this publication. Neither API nor any of API's employees, subcontractors, consultants, or other assignees represent that use of this publication would not infringe upon privately owned rights.

API publications may be used by anyone desiring to do so. Every effort has been made by the Institute to assure the accuracy and reliability of the data contained in them; however, the Institute makes no representation, warranty, or guarantee in connection with this publication and hereby expressly disclaims any liability or responsibility for loss or damage resulting from its use or for the violation of any authorities having jurisdiction with which this publication may conflict.

API publications are published to facilitate the broad availability of proven, sound engineering and operating practices. These publications are not intended to obviate the need for applying sound engineering judgment regarding when and where these publications should be utilized. The formulation and publication of API publications is not intended in any way to inhibit anyone from using any other practices.

Any manufacturer marking equipment or materials in conformance with the marking requirements of an API standard is solely responsible for complying with all the applicable requirements of that standard. API does not represent, warrant, or guarantee that such products do in fact conform to the applicable API standard.

Information concerning safety and health risks and proper precautions with respect to particular materials and conditions should be obtained from the employer, the manufacturer or supplier of that material, or the material safety data sheet.

Where applicable, authorities having jurisdiction should be consulted.

Work sites and equipment operations may differ. Users are solely responsible for assessing their specific equipment and premises in determining the appropriateness of applying the RP. At all times users should employ sound business, scientific, engineering, and judgment safety when using this RP.

API is not undertaking to meet the duties of employers, manufacturers, or suppliers to warn and properly train and equip their employees, and others exposed, concerning health and safety risks and precautions, nor undertaking their obligations to comply with authorities having jurisdiction.

All rights reserved. No part of this work may be reproduced, translated, stored in a retrieval system, or transmitted by any means, electronic, mechanical, photocopying, recording, or otherwise, without prior written permission from the publisher. Contact the Publisher, API Publishing Services, 1220 L Street, NW, Washington, DC 20005.

Foreword

Nothing contained in any API publication is to be construed as granting any right, by implication or otherwise, for the manufacture, sale, or use of any method, apparatus, or product covered by letters patent. Neither should anything contained in the publication be construed as insuring anyone against liability for infringement of letters patent.

Shall: As used in a standard, “shall” denotes a minimum requirement in order to conform to the specification.

Should: As used in a standard, “should” denotes a recommendation or that which is advised but not required in order to conform to the specification.

This document was produced under API standardization procedures that ensure appropriate notification and participation in the developmental process and is designated as an API standard. Questions concerning the interpretation of the content of this publication or comments and questions concerning the procedures under which this publication was developed should be directed in writing to the Director of Standards, American Petroleum Institute, 1220 L Street, NW, Washington, DC 20005. Requests for permission to reproduce or translate all or any part of the material published herein should also be addressed to the director.

Generally, API standards are reviewed and revised, reaffirmed, or withdrawn at least every five years. A one-time extension of up to two years may be added to this review cycle. Status of the publication can be ascertained from the API Standards Department, telephone (202) 682-8000. A catalog of API publications and materials is published annually by API, 1220 L Street, NW, Washington, DC 20005.

Suggested revisions are invited and should be submitted to the Standards Department, API, 1220 L Street, NW, Washington, DC 20005, standards@api.org.

Contents

	Page
1 Scope	1
2 Normative References	1
3 Terms and Definitions	1
4 Conflicting Requirements	2
5 Pipeline Facility Marking Practice	3
5.1 General Description, Use, and Placement of Signage	3
5.2 Types of Posts	3
5.3 Line Markers	6
5.4 Signage	6
5.5 Installation	10
6 Aboveground Pipeline Facility Marking and Signage Practice	12
6.1 Pipelines	12
6.2 Pipeline Facilities Signs	12
6.3 Sign Placement	12
7 Inspections and Maintenance	12
Figures	
1 Examples of Cross Country Right-of-Way Markings	4
2 Examples of Cross Country Markers and Signs	5
3 Line Markers	7
4 Line Marker	8
5 Examples of Surface Markers	9
6 Pipeline Sign for Navigable Waterways	10
7 Typical Aerial Markers	11
8 Typical Pipeline Facility Signs	13

Introduction

Pipelines are, for the most part, buried conduits. As such, they operate safely, quietly, and hidden from view, with little disruption to the public or the surrounding environment. These attributes, which are highly desirable in any mode of transportation, generate the need for an organized system of markers and signs that visually alert the public to the presence of a pipeline and provide a contact number of the Pipeline Operator that can be used in the event of an emergency or before excavating near pipelines. Strategic placement of markers and signs also helps the pipeline operator to perform right-of-way surveillance, inspections and other day-to-day activities. Pipeline markers are an integral component of an Operator's damage prevention and public awareness programs.

This RP was prepared by a committee composed of representatives from pipeline operating companies. Its purpose is to present guidelines concerning the design, fabrication, installation, and maintenance of permanently installed pipeline markers and signs.

Marking Liquid Petroleum Pipeline Facilities

1 Scope

1.1 This recommended practice (RP) addresses the permanent marking of hazardous liquid pipeline transportation facilities. It covers the design, message, installation, placement, inspection, and maintenance of markers and signs on pipeline facilities located onshore and at inland waterway crossings. Markers and signs indicate the presence of a pipeline facility and warn of the potential hazards associated with its presence and operation. The markers and signs may contain information to be used by the public when reporting emergencies and seeking assistance in determining the location of a buried pipeline.

1.2 The provisions of this RP cover the minimum signage (markers and signs) requirements for hazardous liquid pipeline facilities. The pipeline operator is responsible for determining the type and extent of signage. Consideration should be given to the hazardous characteristics of the commodity being transported; the pipeline's proximity to industrial, commercial, residential, and environmentally sensitive areas; susceptibility to excavation-related damage; consequences of failure; and applicable state and federal laws. Several examples of markers and signs with locations are illustrated in Figure 1, Figure 2, Figure 3, Figure 4, Figure 6, and Figure 8. The pipeline marking programs are integral components of the pipeline operator's operations, maintenance and emergency plans, damage prevention programs, and public awareness programs.

2 Normative References

The following referenced documents are indispensable for the application of this document. For dated references, only the edition cited applies. For undated references, the latest edition of the referenced document (including any amendments) applies.

ASME B31.4 ¹, *Liquid Transportation Systems for Hydrocarbons, Liquid, Petroleum Gas, Anhydrous Ammonia, and Alcohols*

49 *Code of Federal Regulations* Part 195 ², "Transportation of Hazardous Liquids by Pipeline"

3 Terms and Definitions

For the purposes of this document, the following definitions apply.

3.1

aerial patrol or air patrol marker

A marker observable from the air, which is used to identify a pipeline's reference location by the aerial patrol pilot while conducting aerial surveillance of a pipeline right-of-way.

NOTE Information on the marker might consist of distance from a point of reference, usually in miles, name or numbers of above ground facilities, direction of the ROW, a Point of Intersection (PI) where the ROW turns, or other information useful to the pilot.

3.2

hazardous liquid

Petroleum, petroleum products, anhydrous ammonia or carbon dioxide and any substance that may pose an unreasonable risk to life or property when transported by a hazardous liquid pipeline facility in a liquid state.

¹ ASME International, 3 Park Avenue, New York, New York 10016-5990, www.asme.org.

² The *Code of Federal Regulations* is available from the U.S. Government Printing Office, Washington, DC 20402.

3.3**line marker or pipeline marker**

Signage used along the pipeline ROW and at above ground pipeline facilities to alert the public and emergency responders of the presence of a pipeline facility. 49 *CFR* Part 195.410 specifies certain locations for line markers and the information to be inscribed on them.

3.4**liquid petroleum**

Crude oil, condensate, natural gas liquids, liquefied petroleum gas, liquid petroleum products, and refined liquid petroleum products.

3.5**other markers**

Signage other than aerial patrol, air patrol marker, line marker, or pipeline marker used to identify the presence of a pipeline facility solely for the benefit of a pipeline operator or to provide additional information concerning the location or facility.

3.6**pipeline facility**

New and existing pipe, rights-of-way, and any equipment or building used in the transportation of liquid petroleum.

3.7**pipeline operator**

Any individual, firm, joint venture, partnership, corporation, association, state, municipality, and cooperative association, including any trustee, receiver, assigned or personal representative thereof, who owns and operates a pipeline system.

3.8**pipeline system**

All parts of a pipeline facility through which hazardous liquid is transported, that includes, but is not limited to, pipe; valves, and other appurtenances connected to the pipe; pumping units, along with the fabricated assemblies associated with the pumping units; metering and delivery stations and fabricated assemblies therein; and breakout tanks.

3.9**sign**

A publicly displayed or posted notice, board, or other device bearing letters, symbols, and/or designs to convey a designation, name, direction, information, instruction, warning, or other message.

3.10**signage—refers to permanent signs collectively**

Aerial patrol or air patrol markers, line markers, pipeline markers, other markers, and signs, such as those around pump stations and breakout stations used to warn or notify the public or emergency responders regarding the presence of a pipeline facility and telephone number of the operator.

NOTE Temporary signage, such as flags, stakes, and other markings used to temporarily mark facilities for the purpose of excavation-related work, is not addressed by this RP.

4 Conflicting Requirements

If any provisions of this RP present a direct or implied conflict with any statutory regulation, the regulation shall govern. However, if this RP's recommendations are more stringent than the requirements of the regulation, then the recommendations presented herein should be considered.

5 Pipeline Facility Marking Practice

5.1 General Description, Use, and Placement of Signage

5.1.1 Signage can be found in various shapes, sizes, and designs. Permanent pipeline facility markers and signs are used to convey the following information to the public and emergency responders:

- a) the presence of a liquid petroleum pipeline facility;
- b) a potential hazard warning;
- c) the contact telephone number of the pipeline operator for any of the following:
 - 1) to determine the location of the buried pipeline,
 - 2) to receive authorization to cross or occupy the pipeline rights-of-way,
 - 3) to report emergencies relating to the pipeline or pipeline right-of-way.

5.1.2 Pipeline personnel may use pipeline markers, aerial markers and other signs to readily identify their pipeline, pipeline right of way, or crossing in the course of various day-to-day operation and maintenance activities or emergency response.

5.1.3 The placement of signage is dependent on the purpose, type of signage, and local conditions. When installing pipeline markers, for example, consideration should be given to installing them on each side of public roads, railroad crossings fence lines, property lines, water crossings, above ground crossings, and other locations accessible to the public. When installing Aerial Markers, consideration should be given to terrain, land use adjoining the ROW, flight path, and physical points along the ROW to be identified, such as PI's and main line—lateral take-offs. When determining the frequency and spacing between markers, consideration should be given to land use, terrain, environment, population density, local ordinances, and other damage prevention considerations such as special excavation activity, one call law exemptions, and frequency of excavated related near misses.

Line Markers should be installed over each pipeline; however, there are locations where it is impractical, such as when a pipeline runs down the middle of the street, parallels the road under the shoulder, or traverses heavily developed urban areas. Line markers that are not placed over the pipeline should denote that the line is offset. Supplemental signage such as curb markers, ground level markers or pavement decals should also be considered.

At a minimum, locations should be chosen to meet or exceed the requirements of 49 *CFR* Part 195.

Examples of cross country right-of-way line markings are shown in Figure 1 and Figure 2.

5.2 Types of Posts

The type of post used will be dependent on the signage used and location. Posts may be made of any materials that will ensure adequate strength, stiffness, visibility, and durability. To maintain structural integrity and appearance, some post materials require surface protection against above- and below-ground corrosion or weathering. A proven coating system that provides a suitable finish and nonfading color should be selected for this purpose. The following criteria should be applied in the selection of marker posts.

- a) Metal pipe posts should be straight, sound, and have a nominal diameter of 2 in. or larger.
- b) Metal structures designed for use as posts may be used.

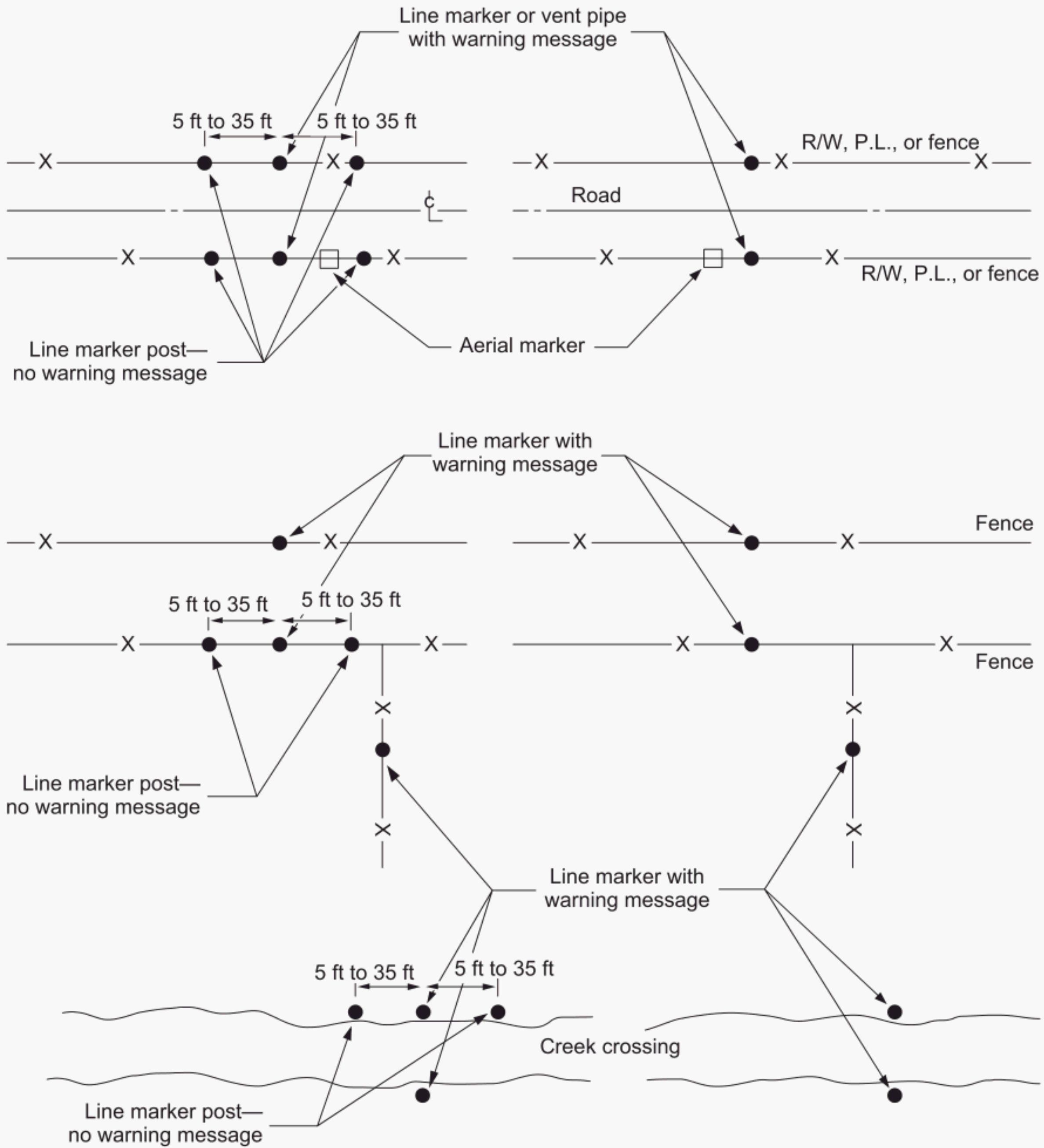

Notes

1. R/W = right-of-way or ROW
2. P.L. = property line

Figure 1—Examples of Cross Country Right-of-Way Markings

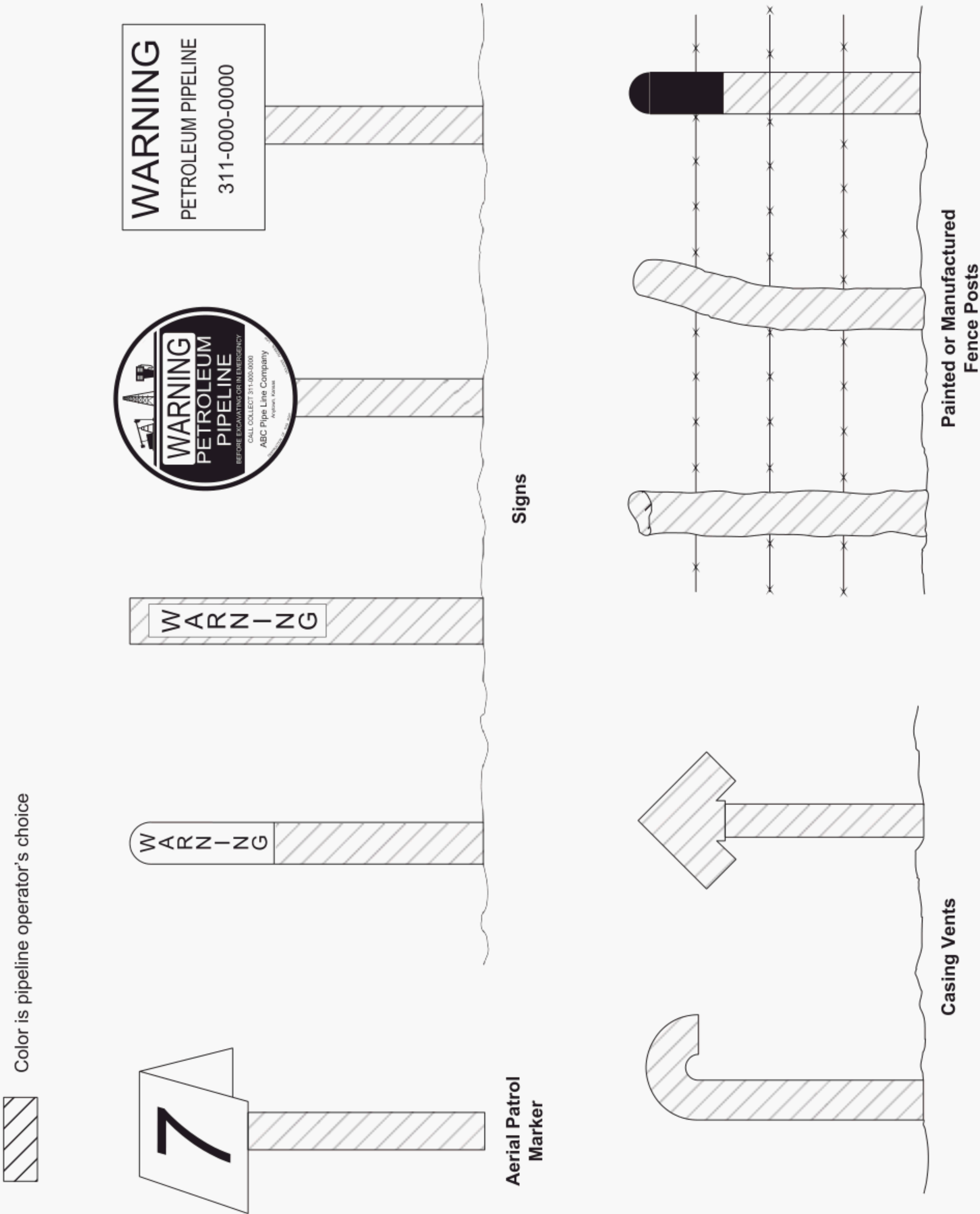

Figure 2—Examples of Cross Country Markers and Signs

- c) Straight posts made from debarked trees and treated with a pressure-applied chemical preservative may be used. The post should be sized to provide multiple years of use with consideration for burial type, burial depth, soil condition, etc. Wood posts are not recommended where brush or grass fires may be expected.
- d) Square precast reinforced-concrete posts having a minimum cross-sectional area of 16 in.² may be used. Special conditions, such as spalling during freeze and thaw cycles, should be considered when specifying material for these types of posts.
- e) Posts made of Polyvinyl-chloride (PVC), Polyethylene, and fiberglass may be used. Materials used, however, should be resistant to ultraviolet exposure and suited to the environment where installed (see Figure 3).
- f) Other materials are acceptable provided they meet the general criteria discussed above.

5.3 Line Markers

5.3.1 Part 195 of 49 *CFR* requires that certain information be presented on line markers in lettering of a certain size and stroke. The regulations further require that line markers be placed over all buried pipeline at each public road crossing, at each railroad crossing, and in sufficient numbers along the remainder of each buried pipeline so that its location is accurately known.

5.3.2 The line marker's message should be presented on strong, durable material finished to resist the effects of exposure and vandalism. The message should state at least the following: "WARNING," followed by the words "PETROLEUM [or the name of the liquid petroleum transported] PIPELINE." The lettering should be at least 1 in. high with an approximate stroke of 1/4 in. on a background of sharply contrasting color. It should also contain the name of the pipeline operator with a telephone number, including an area code, where the pipeline operator can be reached at all times.

5.3.3 The line markers depicted in Figure 3 and Figure 4 are examples of line markers in general use by the liquid petroleum pipeline industry. The dimensions, wording, colors, and configuration shown on the figures are recommended for good visibility. The size and style of the lettering identifying the pipeline operator are optional. A trademark or other identifying symbol may appear as part of the pipeline operator's identification.

5.3.4 Caution should be used when installing a line marker anywhere other than directly over or in proximity to the buried pipeline to avoid any possible misinterpretation as to where the actual pipeline is located.

5.4 Signage

5.4.1 The pipeline operator may use markers and signs in addition to line markers to aid in determining the locations of the pipeline. Examples of such markers are listed below:

- a) aerial patrol markers;
- b) prominently colored posts at fences, and right-of-way limits of roads and railroads;
- c) markers at banks of water crossings;
- d) stenciled markings on the surface of pavements (see Figure 5);
- e) buried tape or warning mesh;
- f) casing vents;
- g) cathodic protection test stations;
- h) any other kind of marker the operator recognizes as necessary in such locations.

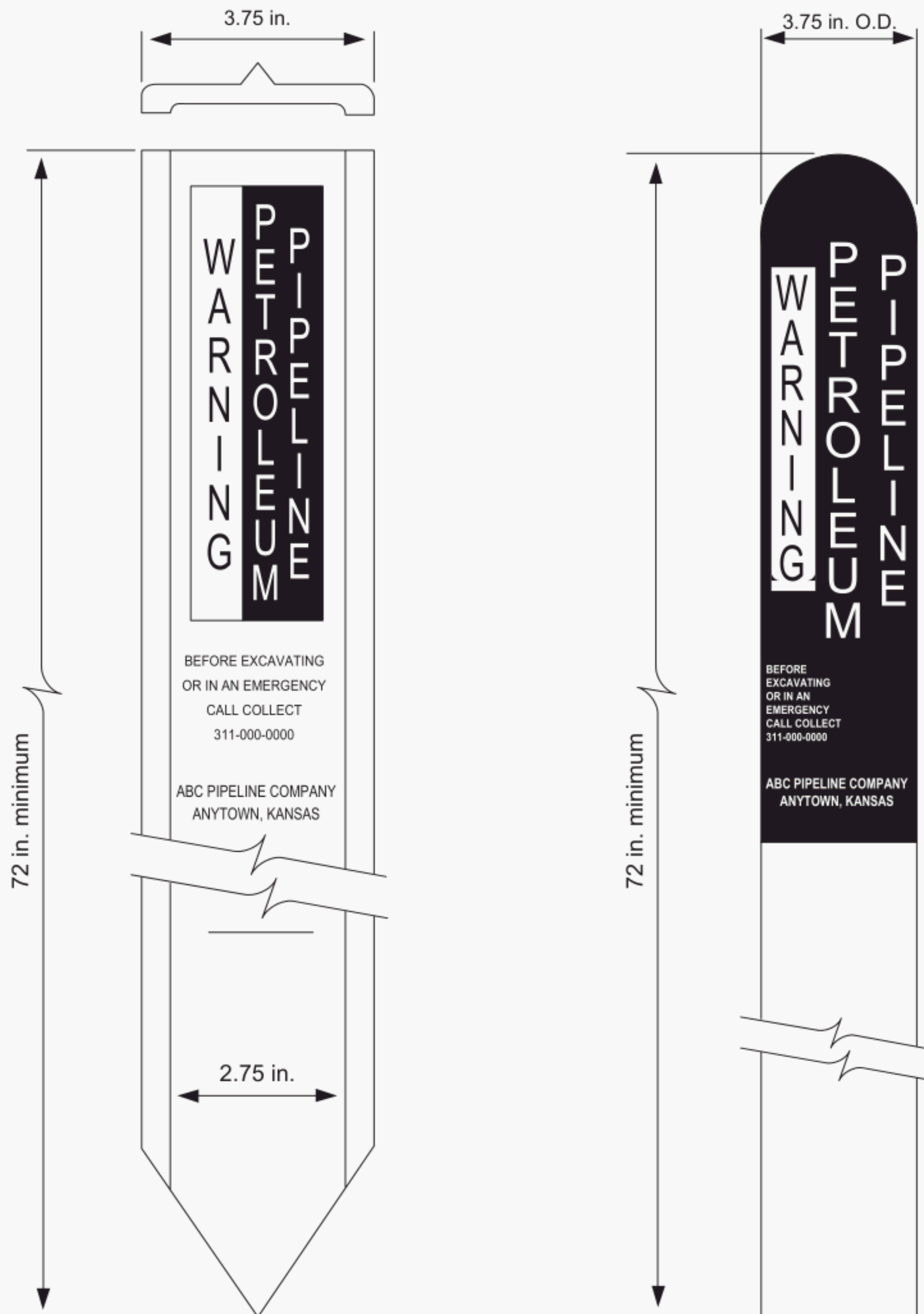
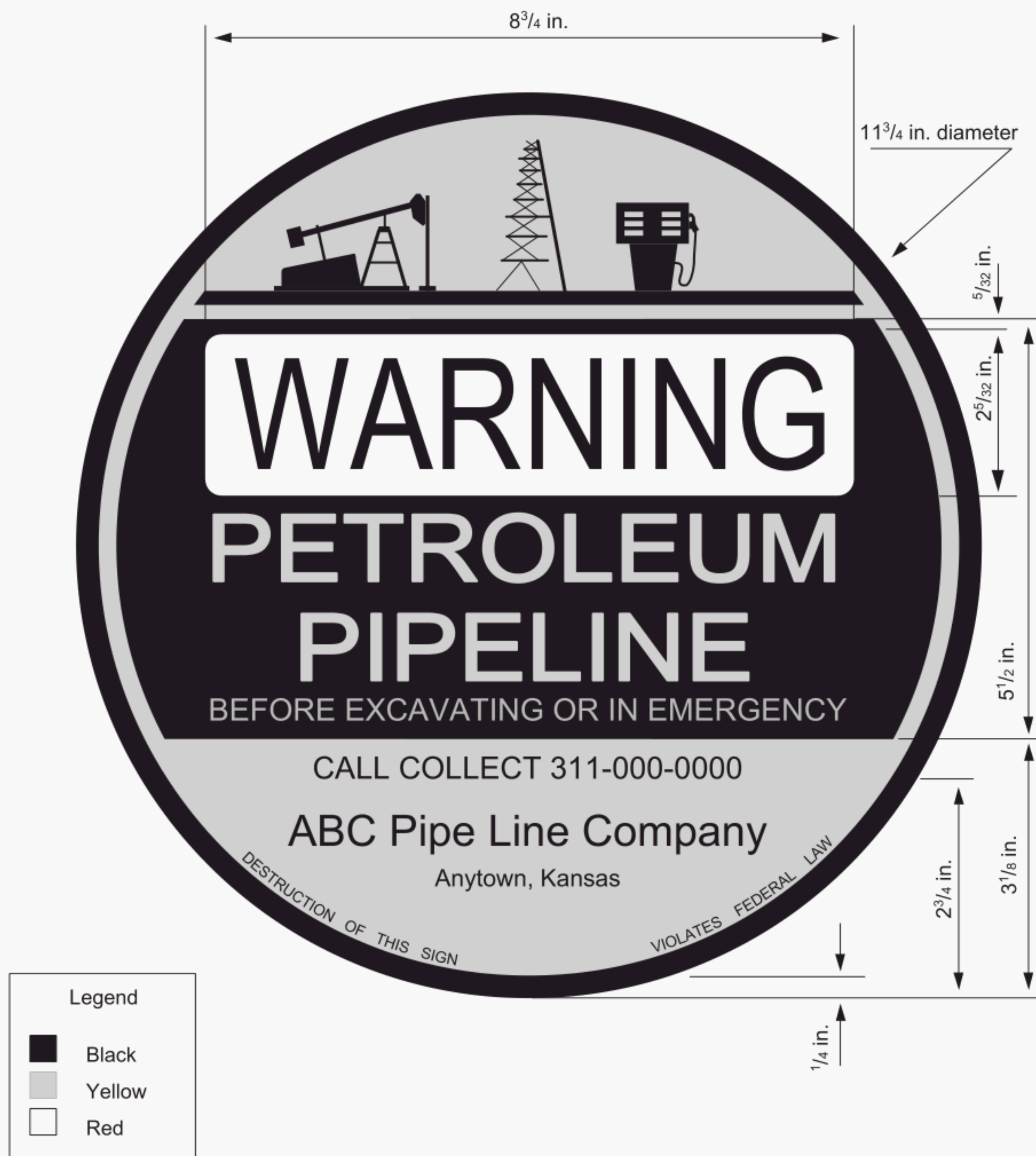

Figure 3—Line Markers

5.4.2 When signs are used to identify pipeline crossings at navigable waterways they should contain the words “DO NOT ANCHOR OR DREDGE.” The sign’s lettering should not be less than 12 in. high, with an approximate stroke of $1\frac{3}{4}$ in. on a background of sharply contrasting color. This lettering is in addition to the information recommended in 5.3.2. Because government agencies or authorities may share jurisdiction over certain navigable waterways, the specifications for and placement of markers for a particular waterway should satisfy those joint requirements. Many agencies accept or adopt the requirements of the United States Army Corps of Engineers. Figure 6 shows an appropriate navigable waterway sign.



Notes

1. Recommended color samples of the red and yellow to be used on this sign are available on loan from the American Petroleum Institute's Manufacturing, Distribution, and Marketing Department.
2. Minor variations in letter style are acceptable provided that the minimum letter size and stroke width recommendations in 5.3.2 are accepted.
3. Sign to have 4⁹/₃₂ in. holes on 11 in. b.c. at vertical and horizontal centerlines.

Figure 4—Line Marker

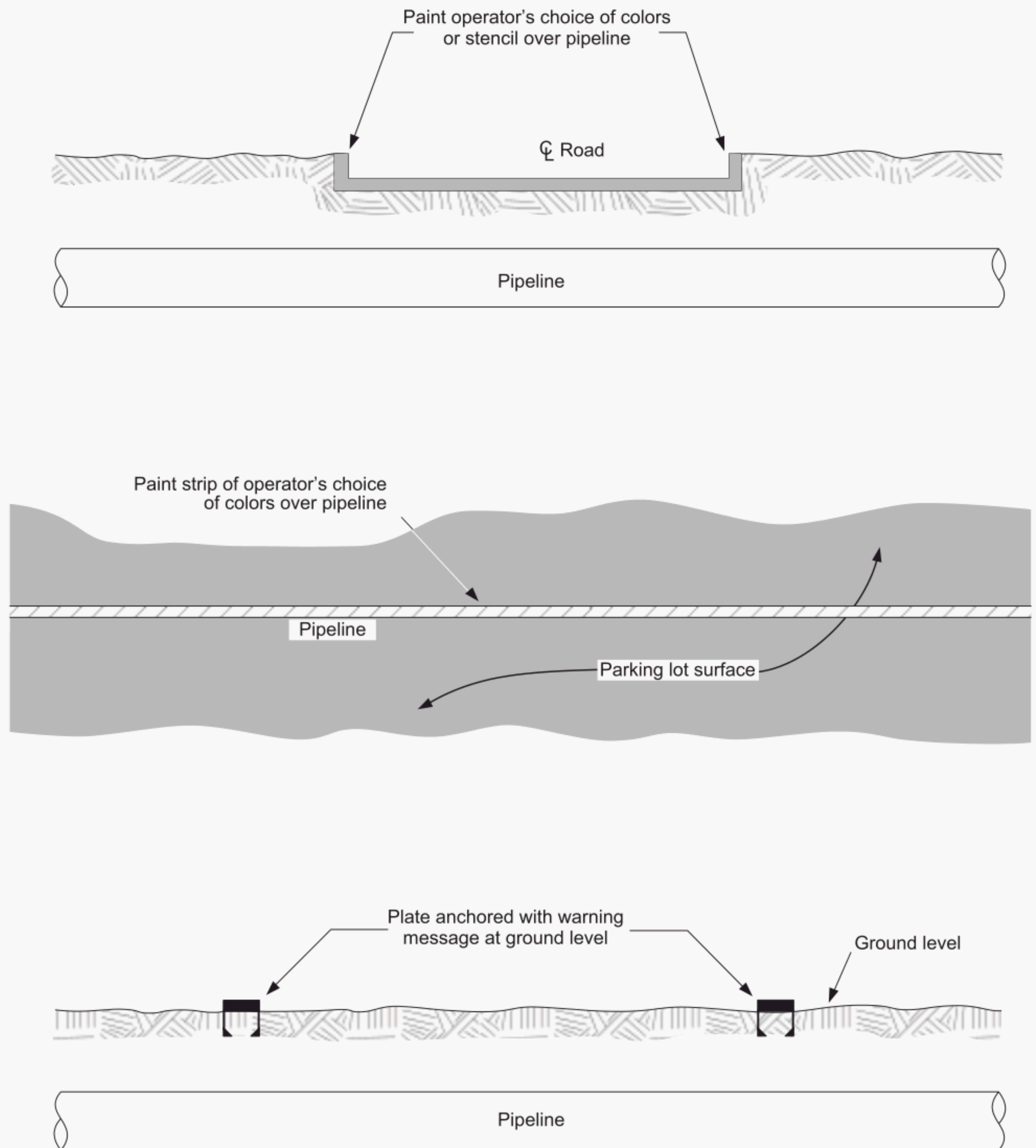
**Figure 5—Examples of Surface Markers**

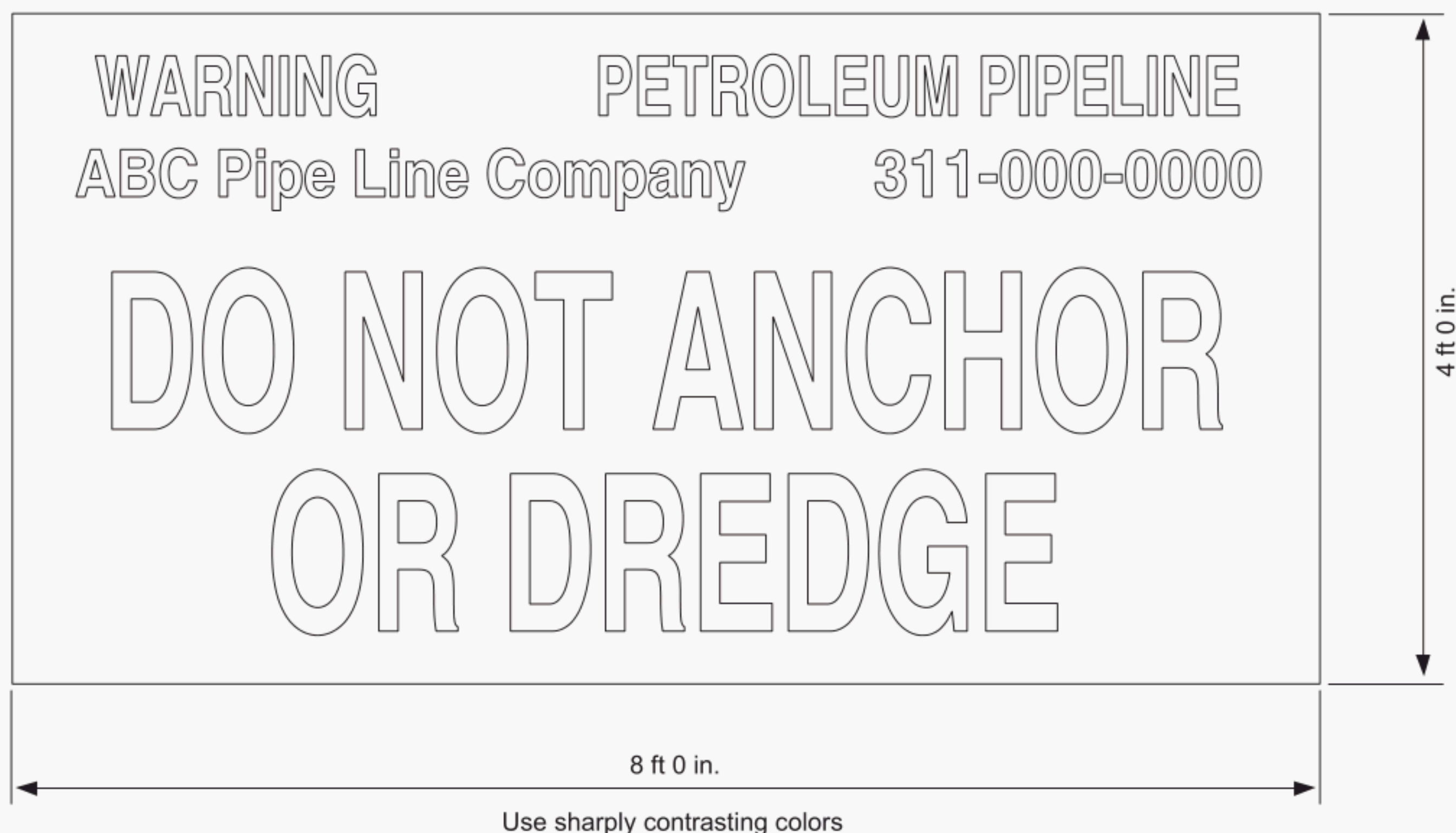

Figure 6—Pipeline Sign for Navigable Waterways

5.4.3 The pipeline operator may elect to place markers of special design in particular locations where current or projected activities of others may warrant their installation. Consideration should be given to whether the markers are for temporary or permanent service.

5.4.4 Aerial patrol markers may be used along the routes of pipelines that are patrolled by aircraft. Figure 7 is an example of a typical aerial marker. When used, aerial markers should be placed or positioned at locations where they can easily be identified from the air.

5.5 Installation

5.5.1 Typically, the message portion of any marker is attached to, or is an integral part of, a post of the type described in 5.2.

5.5.2 The following factors should be considered in determining the depth to bury marker posts:

- a) post material;
- b) method of installation;
- c) type of soil;
- d) state of soil consolidation;
- e) depth of frost line and propensity of soil to heave;

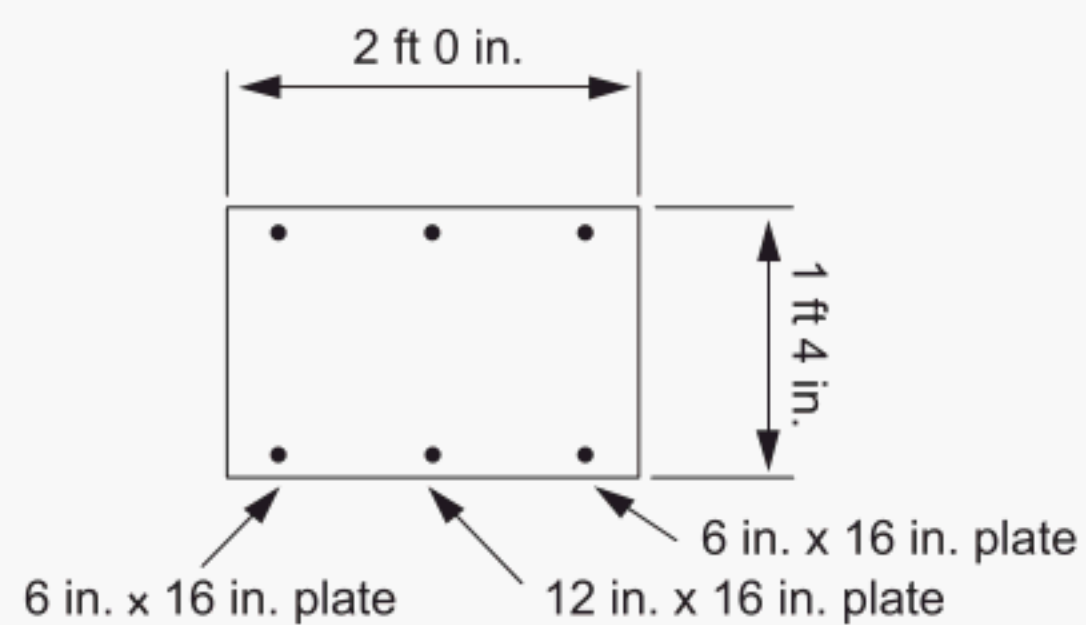
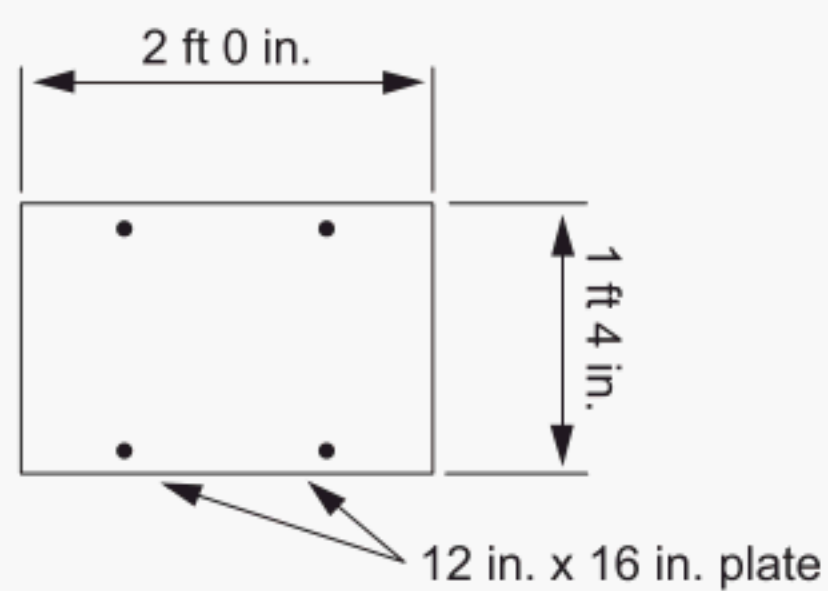
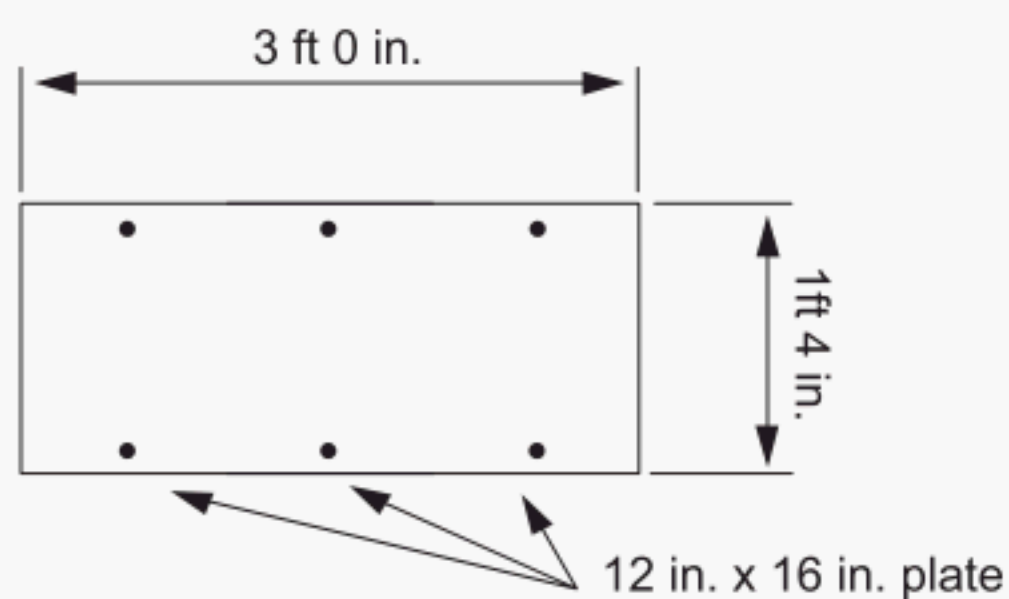
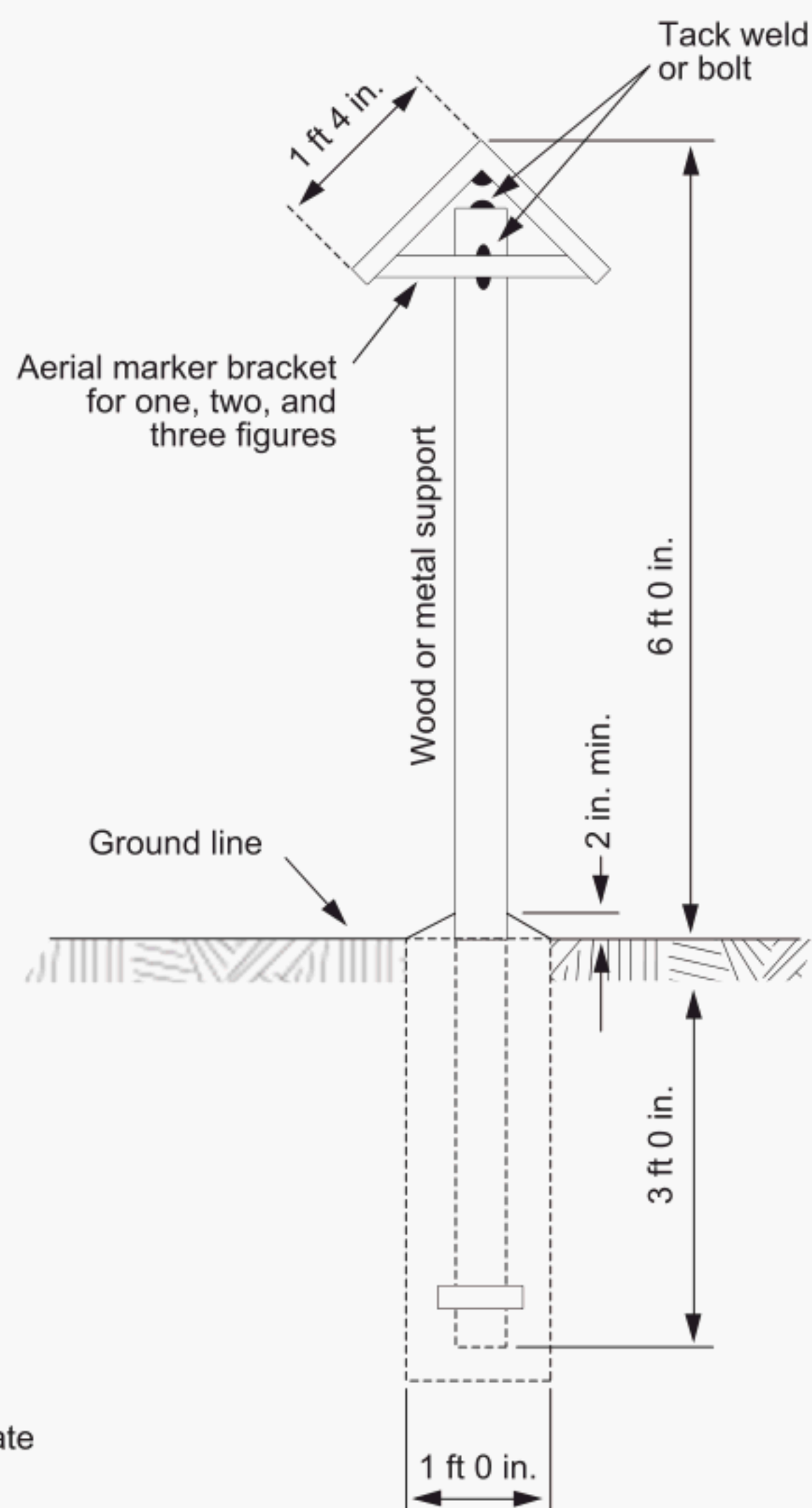
**1 Figure Marker****2 Figure Marker****3 Figure Marker**

Use sharply contrasting colors

Figure 7—Typical Aerial Markers

- f) size, shape, height, and weight of the pipeline marker assembly;
- g) exposure to external forces such as wind, high water, currents, large livestock, or wildlife;
- h) depth of pipeline to be marked.

Consideration should also be given to attaching the message portion of any marker to pipeline vent pipes, fences, fence posts, or other existing posts to reduce the overall clutter at the site, provided that in the case of line markers, the requirements noted in 5.3.1 are met.

5.5.3 Aboveground markers should be sufficiently elevated to allow them to be clearly viewed from a distance, and to allow them to remain visible above normal vegetation or snow accumulation. A minimum height of 4 ft above grade is recommended. The effect that agriculture use and/or type of crops raised has on the visibility of the marker should be considered when determining the location and height of the marker.

5.5.4 When necessary, the post holes should be backfilled with concrete.

5.5.5 When installing posts, caution should be exercised to avoid underground structures.

5.5.6 The bottom of posts may be modified or fitted with transverse members to inhibit unauthorized removal or ejection by frost heaving.

6 Aboveground Pipeline Facility Marking and Signage Practice

6.1 Pipelines

Part 195 of 49 *CFR* requires that line markers be installed at locations where the pipeline is aboveground in areas that are accessible to the public.

6.2 Pipeline Facilities Signs

Pipeline facilities such as stations, terminals, tank farms, valves, metering, or pipeline junction manifolds should be marked with appropriate signage. Figure 8 shows examples of signs. These signs should contain the name of the pipeline operator with a telephone number, including an area code, where the pipeline operator can be reached at all times and the name of the facility. The signs may also contain other data, such as the type or name of the facility, a mailing address, instructions, prohibitions, and warnings.

6.3 Sign Placement

Pipeline facility signs should be placed on all sides of the facility accessible to the public, at the facility entrance or entrances, and in sufficient numbers so that the facility is clearly identified.

7 Inspections and Maintenance

The inspection, maintenance, and replacement of markers and signs should be a part of the pipeline operator's regular maintenance procedures. Markers and signs, along with their supporting structures, should be maintained in their original state of effectiveness. Damaged, defaced, or missing markers and signs should be replaced. Markers and signs should not be obscured by vegetation. Markers and signs whose effectiveness has been compromised by construction, damage, or fading should be relocated or replaced to restore effective marking.

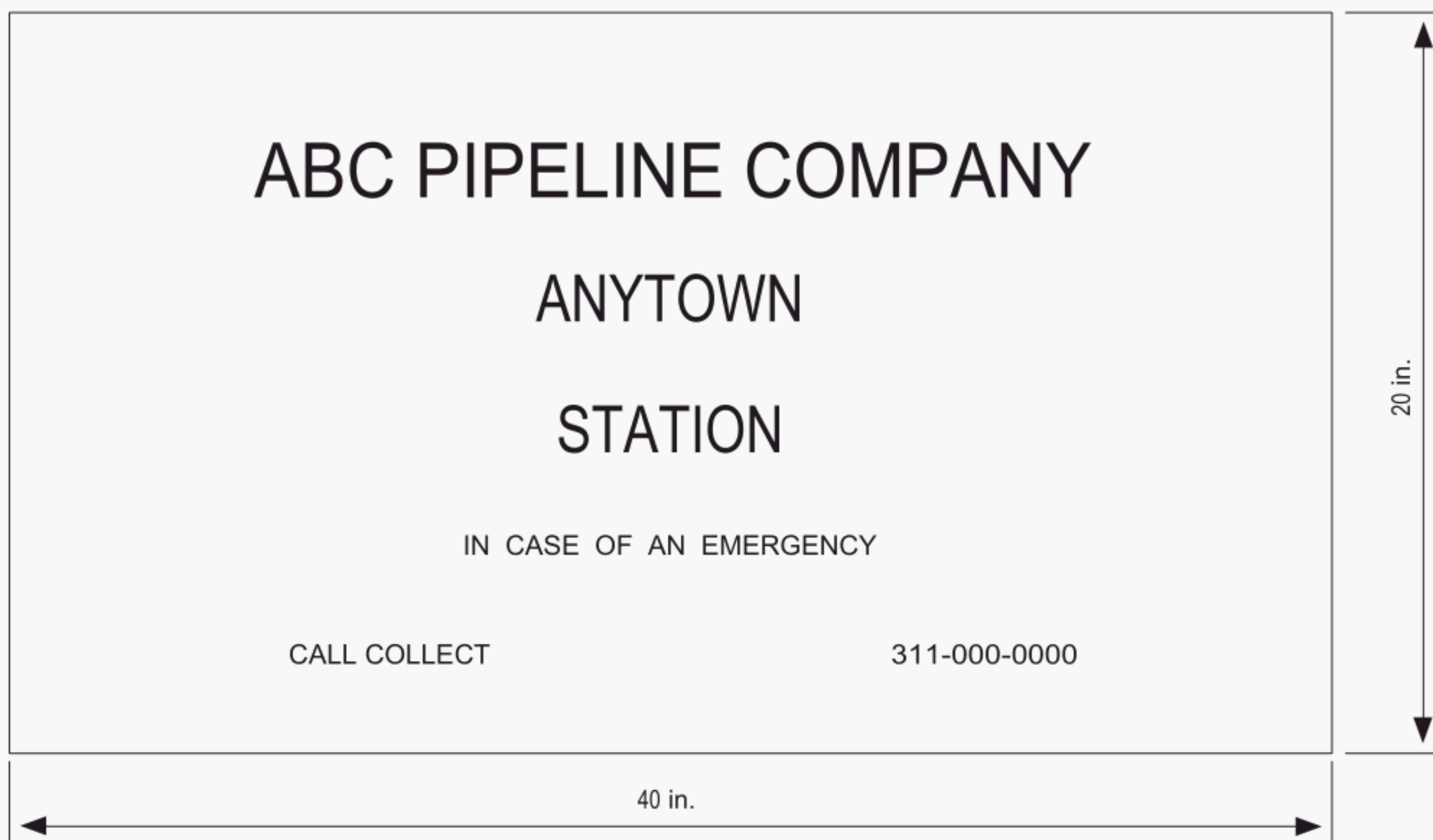
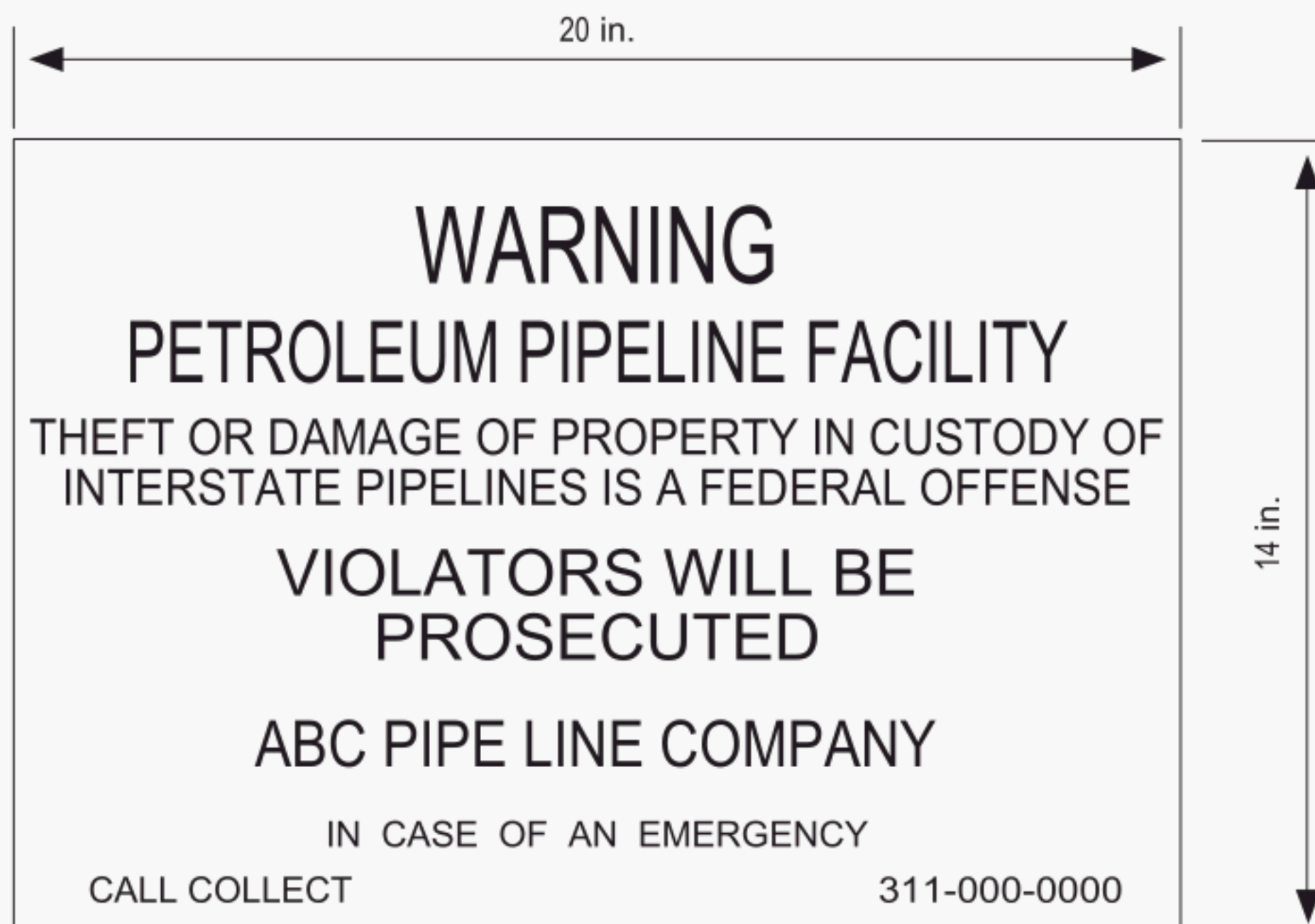
**Figure 8—Typical Pipeline Facility Signs**



AMERICAN PETROLEUM INSTITUTE

2010 PUBLICATIONS ORDER FORM

Effective January 1, 2010. API Members receive a 30% discount where applicable. The member discount does not apply to purchases made for the purpose of resale or for incorporation into commercial products, training courses, workshops, or other commercial enterprises.

Ordering Information Online: www.api.org/pubs
Phone: **1-800-854-7179** (Toll-free in the U.S. and Canada) | **(+1) 303-397-7956** (Local and International)
Fax: **(+1) 303-397-2740**

Date: _____

☐ **API Member** (Check if Yes)

Invoice To (☐ Check here if same as "Ship To")

Name: _____

Title: _____

Company: _____

Department: _____

Address: _____

City: _____ State/Province: _____

Zip/Postal Code: _____ Country: _____

Telephone: _____

Fax: _____

Email: _____

Ship To (UPS will not deliver to a P.O. Box)

Name: _____

Title: _____

Company: _____

Department: _____

Address: _____

City: _____ State/Province: _____

Zip/Postal Code: _____ Country: _____

Telephone: _____

Fax: _____

Email: _____

Quantity	Title	SO★	Unit Price	Total
	Std 1160, Managing System Integrity for Hazardous Liquid Pipelines		\$186.00	
	Std 1162, Public Awareness Programs for Pipeline Operators		\$93.00	

☐ Payment Enclosed ☐ P.O. No. (Enclose Copy) _____

☐ Charge My IHS Account No. _____

☐ VISA ☐ MasterCard ☐ American Express

☐ Diners Club ☐ Discover

Credit Card No.: _____

Print Name (As It Appears on Card): _____

Expiration Date: _____

Signature: _____

Subtotal _____

Applicable Sales Tax (see below) _____

Rush Shipping Fee (see below) _____

Shipping and Handling (see below) _____

Total (in U.S. Dollars) _____

★ To be placed on Standing Order for future editions of this publication, place a check mark in the SO column and sign here:

Pricing and availability subject to change without notice.

Mail Orders – Payment by check or money order in U.S. dollars is required except for established accounts. State and local taxes, \$10 processing fee, and 5% shipping must be added. Send mail orders to: **API Publications, IHS, 15 Inverness Way East, c/o Retail Sales, Englewood, CO 80112-5776, USA.**

Purchase Orders – Purchase orders are accepted from established accounts. Invoice will include actual freight cost, a \$10 processing fee, plus state and local taxes.

Telephone Orders – If ordering by telephone, a \$10 processing fee and actual freight costs will be added to the order.

Sales Tax – All U.S. purchases must include applicable state and local sales tax. Customers claiming tax-exempt status must provide IHS with a copy of their exemption certificate.

Shipping (U.S. Orders) – Orders shipped within the U.S. are sent via traceable means. Most orders are shipped the same day. Subscription updates are sent by First-Class Mail. Other options, including next-day service, air service, and fax transmission are available at additional cost. Call 1-800-854-7179 for more information.

Shipping (International Orders) – Standard international shipping is by air express courier service. Subscription updates are sent by World Mail. Normal delivery is 3-4 days from shipping date.

Rush Shipping Fee – Next Day Delivery orders charge is \$20 in addition to the carrier charges. Next Day Delivery orders must be placed by 2:00 p.m. MST to ensure overnight delivery.

Returns – All returns must be pre-approved by calling the IHS Customer Service Department at 1-800-624-3974 for information and assistance. There may be a 15% restocking fee. Special order items, electronic documents, and age-dated materials are non-returnable.

THERE'S MORE WHERE THIS CAME FROM.

API Monogram® Licensing Program

Sales: (+1) 713-964-2662
Service: (+1) 202-962-4791
Fax: (+1) 202-682-8070
Email: certification@api.org
Web: www.api.org/monogram

API Quality Registrar (APIQR®)

- ISO 9001
- ISO/TS 29001
- ISO 14001
- OHSAS 18001
- API Spec Q1®
- API QualityPlus®
- Dual Registration

Sales: (+1) 713-964-2662
Service: (+1) 202-962-4791
Fax: (+1) 202-682-8070
Email: certification@api.org
Web: www.api.org/apiqr

API Individual Certification Programs (ICP®)

Sales: (+1) 713-964-2662
Service: (+1) 202-682-8064
Fax: (+1) 202-682-8348
Email: icp@api.org
Web: www.api.org/icp

API Engine Oil Licensing and Certification System (EOLCS)

Sales: (+1) 713-964-2662
Service: (+1) 202-682-8516
Fax: (+1) 202-962-4739
Email: eolcs@api.org
Web: www.api.org/eolcs

API Training Provider Certification Program (API TPCP™)

Sales: (+1) 713-964-2662
Service: (+1) 202-682-8075
Fax: (+1) 202-682-8070
Email: tpcp@api.org
Web: www.api.org/tpcp

API Perforator Design Registration Program

Sales: (+1) 713-964-2662
Service: (+1) 202-682-8490
Fax: (+1) 202-682-8070
Email: perfdesign@api.org
Web: www.api.org/perforators

API Credit Exchange (ACE™)

Service: (+1) 202-682-8192
Fax: (+1) 202-682-8070
Email: exchange@api.org
Web: www.api.org/ace

API Diesel Exhaust Fluid Certification Program

Phone: (+1) 202-682-8516
Fax: (+1) 202-962-4739
Email: info@apidef.org
Web: www.apidef.org

API WorkSafe™

Sales: (+1) 713-964-2662
Service: (+1) 202-682-8469
Fax: (+1) 202-682-8348
Email: apiworksafe@api.org
Web: www.api.org/worksafe

API-U

Phone: (+1) 202-682-8053
Fax: (+1) 202-682-8070
Email: training@api.org
Web: www.api-u.org

API Data™

Phone: (+1) 202-682-8499
Fax: (+1) 202-962-4730
Email: apidata@api.org
Web: www.APIDataNow.org

API Publications

Online: www.api.org/pubs
Phone: 1-800-854-7179
(Toll-free: U.S./Canada)
(+1) 303-397-7956
(Local/International)
Fax: (+1) 303-397-2740

API Standards

Phone: (+1) 202-682-8148
Fax: (+1) 202-962-4797
Email: standards.org
Web: www.api.org/standards

Request a Quotation:
www.api.org/quote



AMERICAN PETROLEUM INSTITUTE



AMERICAN PETROLEUM INSTITUTE

1220 L Street, NW
Washington, DC 20005-4070
USA

202-682-8000

Additional copies are available online at www.api.org/pubs

Phone Orders: 1-800-854-7179 (Toll-free in the U.S. and Canada)
303-397-7956 (Local and International)
Fax Orders: 303-397-2740

Information about API publications, programs and services is available
on the web at www.api.org.

Product No. D11094